

Thermal Chimney's- installed above insulation in attic. Hot attic heats chimneys and moves air up and out automatically. The hotter the weather the faster air will move.

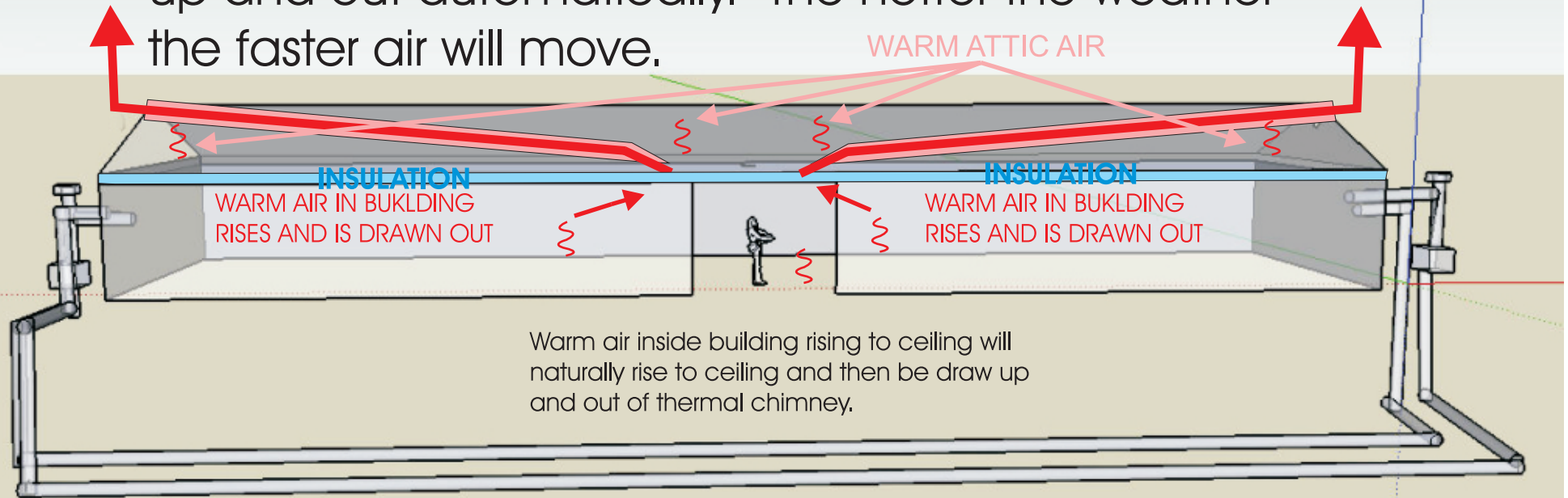

Warm air inside building rising to ceiling will naturally rise to ceiling and then be draw up and out of thermal chimney.

NO ELECTRICITY OR FANS NEEDED TO CIRCULATE AIR IN HOT CONDITIONS.

In cold conditions, close vents to prevent cold outside air from entering thermal vents.

COLD OR HUMID

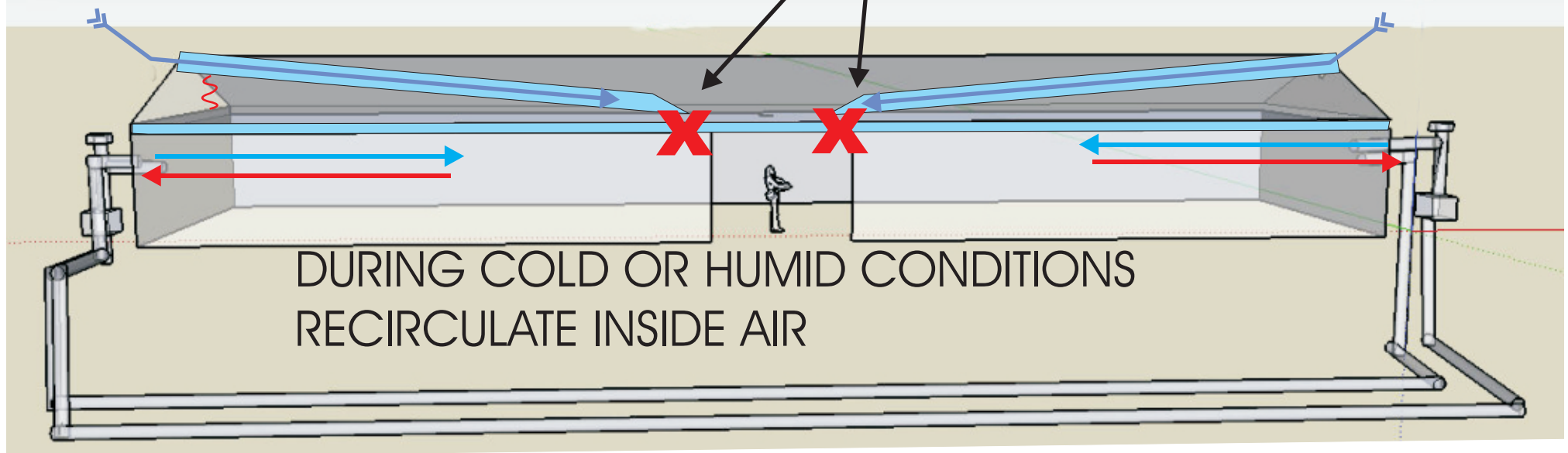

Each half of the building will need to be relatively "sealed" so that air will efficiently move through earth tubes and up and out thermal chimney.

Doors weatherstripped w/self closers
Windows closed.
Outdoor vents on lower level closed

**FANS WOULD BE NEEDED
WHENEVER RECIRCULATING
AIR IS NECESSARY (IN COLD
OR VERY HUMID CONDITIONS)**



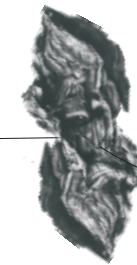

INSTALL TUBES WITH CABLE STRUNG THROUGH INSIDE, TO
ALLOW ATTACHING BLEACH SOAKED TOWEL THAT CAN BE
DRAWN THROUGH TO STERILIZE AND PREVENT MOLD/MILDEW.

100

95

75

25

5

0